

**Power Inductor SLFA Series**

**Automotive  
AEC-Q200**

RoHS Compliant  
Halogen Free  
REACH Compliant



**Part Numbering**

SLFA	1255	T	-	100	M	-	AU
Series Name	Dimensions Code (mm)	Internal Code		Inductance (uH)	Tolerance		Internal Code
	0745 7.3x7.3x4.8			6R0 6.0	M ±20%		
	0755 7.3x7.3x5.8			100 10	T ±30%		
	1255 12.5x12.5x5.8			101 100			
	5D28 6.3x6.3x3.0						

**Power Inductor SLFA Series**

**Automotive  
AEC-Q200**

**SLFA0745 - AU Type**

**■ Dimensions**

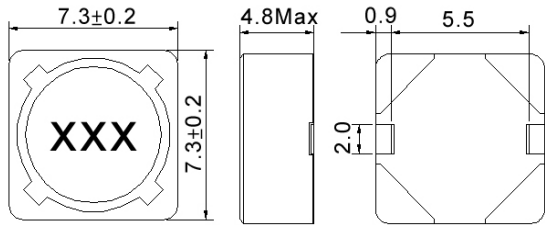

unit:mm

**■ Recommended Land Pattern**

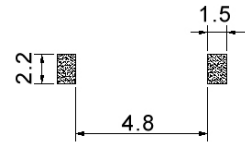

unit:mm

**■ Electrical Characteristics**

Part No.	Inductance (uH)	Test Freq.	SRF (MHz)Min	RDC (mΩ)Max.	Isat (A)	Irms (A)	Tolerance (±%)	Marking
SLFA0745T-3R3□-AU	3.3	100 kHz,1 V	90	24	2.50	2.30	20	3R3
SLFA0745T-4R7□-AU	4.7	100 kHz,1 V	65	36	2.00	2.10	20	4R7
SLFA0745T-6R8□-AU	6.8	100 kHz,1 V	24	40	1.70	1.74	20	6R8
SLFA0745T-100□-AU	10	100 kHz,1 V	17	43.2	1.30	1.78	20	100
SLFA0745T-150□-AU	15	100 kHz,1 V	14	62.4	1.10	1.53	20	150
SLFA0745T-220□-AU	22	100 kHz,1 V	11	73.2	0.90	1.34	20	220
SLFA0745T-330□-AU	33	100 kHz,1 V	10	115	0.82	1.09	20	330
SLFA0745T-470□-AU	47	100 kHz,1 V	8.0	150	0.75	0.92	20	470
SLFA0745T-680□-AU	68	100 kHz,1 V	7.0	210	0.60	0.77	20	680
SLFA0745T-101□-AU	100	100 kHz,1 V	6.0	300	0.50	0.65	20	101
SLFA0745T-151□-AU	150	100 kHz,1 V	4.0	408	0.40	0.55	20	151
SLFA0745T-221□-AU	220	100 kHz,1 V	3.5	624	0.33	0.45	20	221
SLFA0745T-331□-AU	330	100 kHz,1 V	3.0	880	0.25	0.37	20	331
SLFA0745T-471□-AU	470	100 kHz,1 V	2.5	1260	0.22	0.31	20	471
SLFA0745T-681□-AU	680	100 kHz,1 V	2.1	1770	0.20	0.27	20	681
SLFA0745T-102□-AU	1000	100 kHz,1 V	1.1	2730	0.14	0.25	20	102

**Note: When ordering, please specify tolerance code. Tolerance: M=±20% / T=±30%**

1. Operating temperature range - 40°C ~ 125°C(Including self - temperature rise)
2. Isat for Inductance drop 10% from its value without current.
3. Irms for a 20°C temprature rise from 25°C ambient.
4. Measure Equipment:

L: WK6500B+WK6565  
RDC: Chroma 16502  
Isat: WK3260B+WK3265B

**Power Inductor SLFA Series**

**Automotive  
AEC-Q200**

**SLFA0745 - AU Type**

**■ Characteristics Graph**

**Inductance vs. Frequency Charateristics**

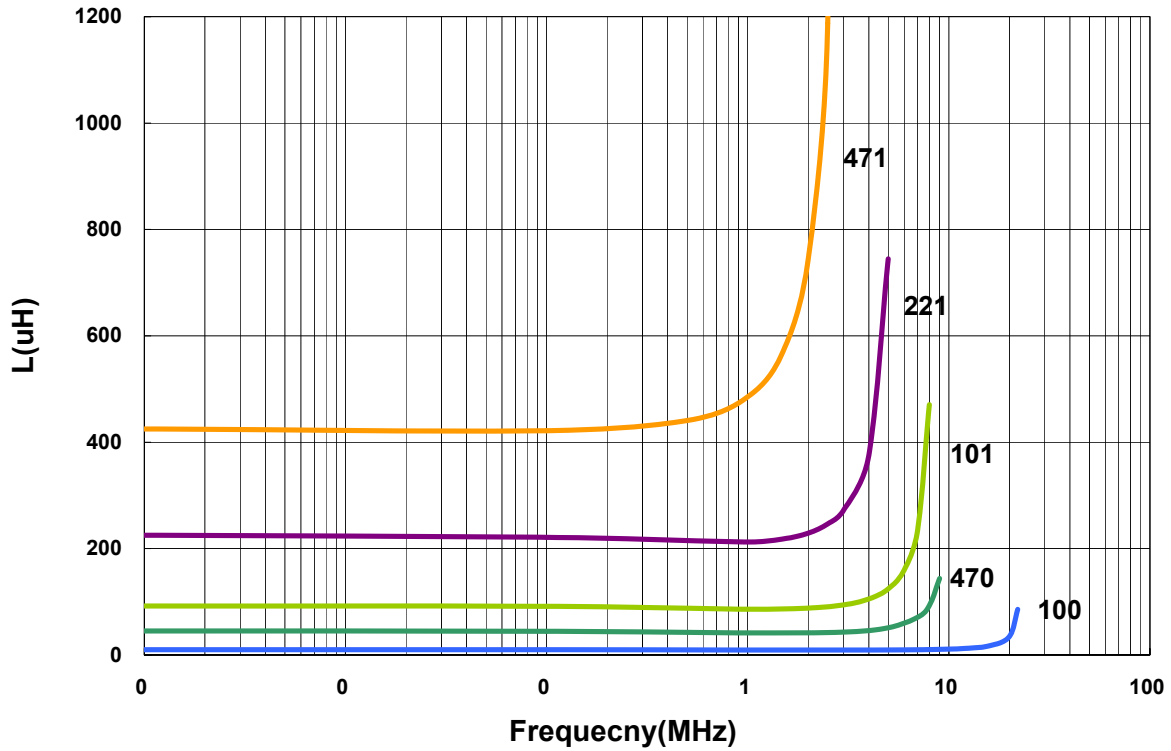

**Inductance vs. DC Current**

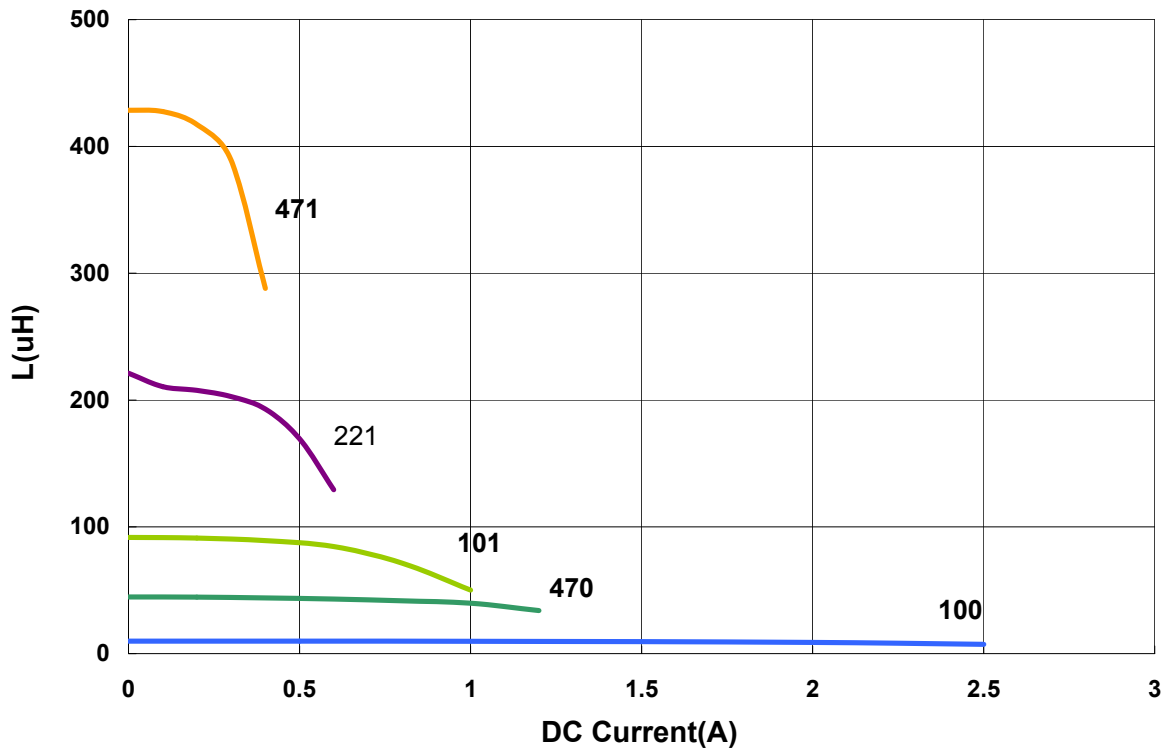

"Please be sure to request approval specifications that provide further details of the products. Kindly note that the content of these specifications are subject to change or may be discontinued without advance notice. Please contact our sales department before ordering."

**Power Inductor SLFA Series**

**Automotive  
AEC-Q200**

**SLFA0755 - AU Type**

**■ Dimensions**

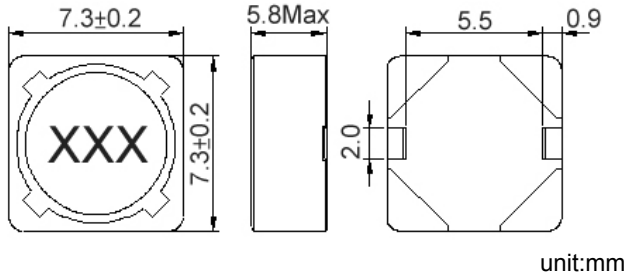

**■ Recommended Land Pattern**

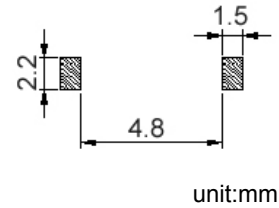

**■ Electrical Characteristics**

Part No.	Inductance (uH)	Test Freq.	SRF (MHz)Min	RDC (mΩ)Max.	Isat (A)	Irms (A)	Tolerance (±%)	Marking
SLFA0755T-1R5□-AU	1.5	100 kHz,1 V	75	20	6.2	4.0	30	1R5
SLFA0755T-2R2□-AU	2.2	100 kHz,1 V	55	23	5.3	3.5	30	2R2
SLFA0755T-3R3□-AU	3.3	100 kHz,1 V	48	31	4.3	3.3	30	3R3
SLFA0755T-4R7□-AU	4.7	100 kHz,1 V	38	36	3.6	3.1	30	4R7
SLFA0755T-6R8□-AU	6.8	100 kHz,1 V	35	44	3.0	2.8	30	6R8
SLFA0755T-100□-AU	10	100 kHz,1 V	22	46	2.6	2.5	20	100
SLFA0755T-150□-AU	15	100 kHz,1 V	14	60.9	2.1	2.2	20	150
SLFA0755T-220□-AU	22	100 kHz,1 V	8	77	1.7	2.0	20	220

**Note: When ordering, please specify tolerance code. Tolerance: M=±20% / T=±30%**

1. Operating temperature range - 40°C ~ 125°C(Including self - temperature rise)
2. Isat for Inductance drop 10% from its value without current.
3. I rms for a 30°C temprature rise from 25°C ambient.
4. Measure Equipment:  
 L: WK6500B+WK6565  
 RDC: Chroma 16502  
 Isat: WK3260B+WK3265B

SLFA0755 - AU Type

■ Characteristics Graph

Inductance vs. Frequency Charateristics

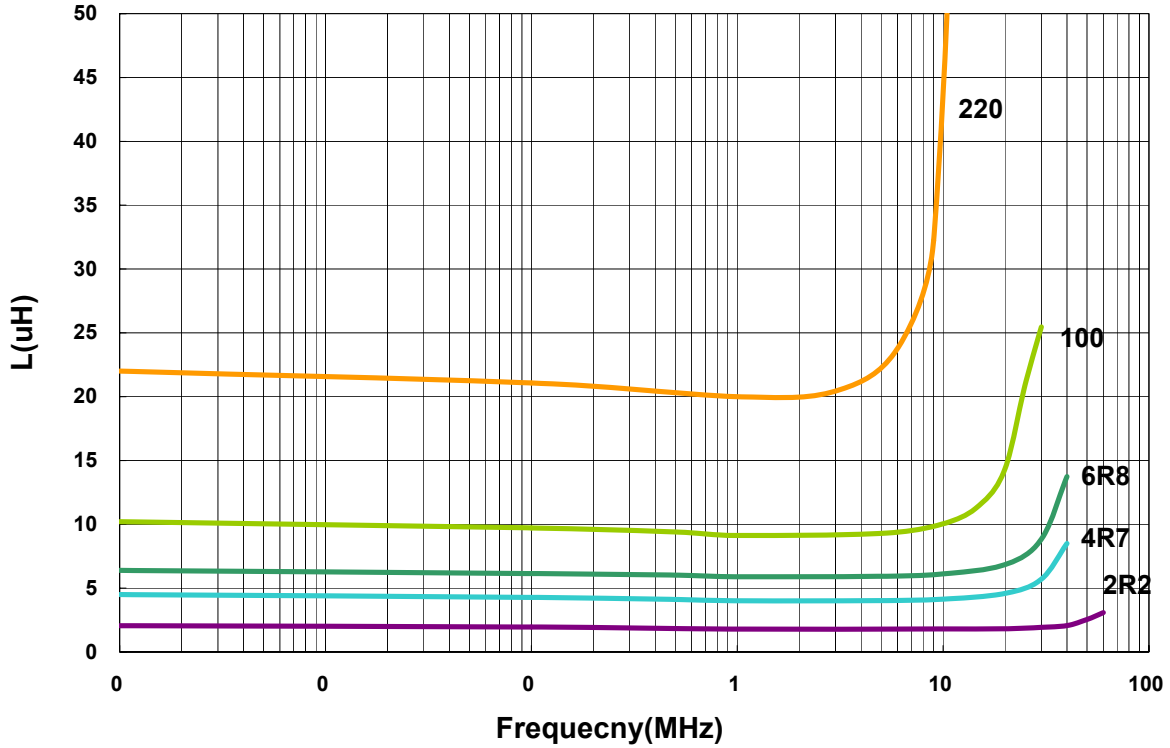

Inductance vs. DC Current

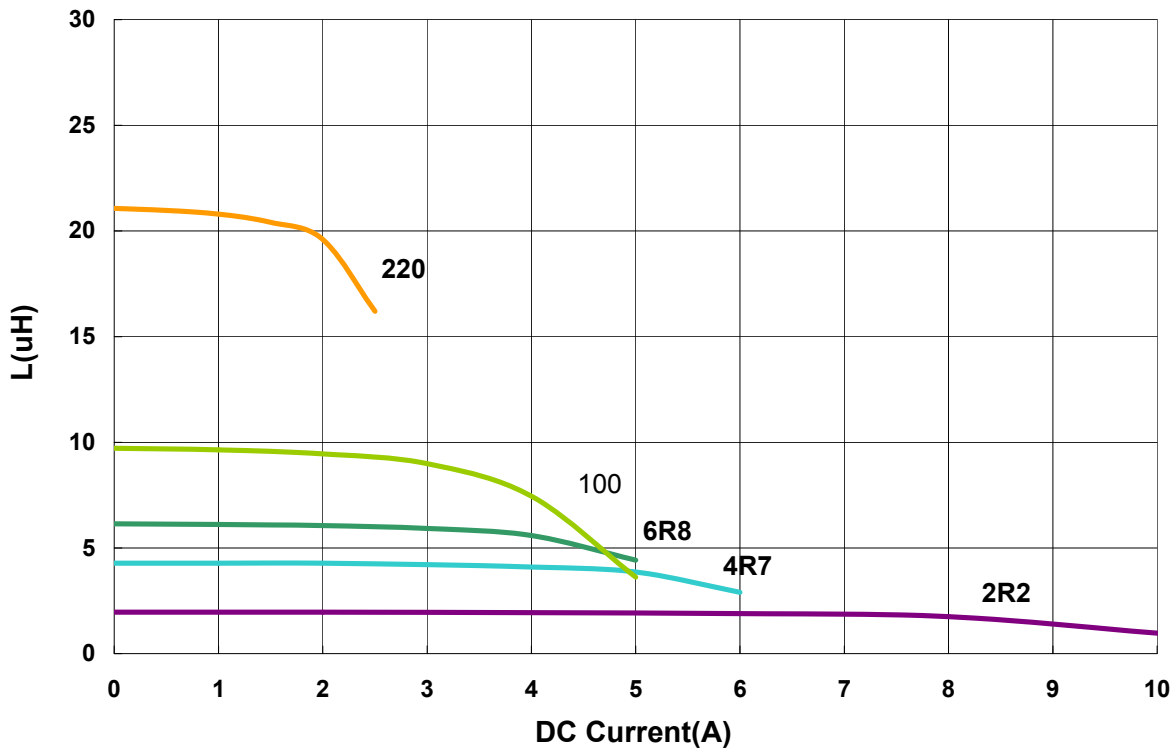

"Please be sure to request approval specifications that provide further details of the products. Kindly note that the content of these specifications are subject to change or may be discontinued without advance notice. Please contact our sales department before ordering."

**Power Inductor SLFA Series**

**Automotive  
AEC-Q200**

**SLFA1255 - AU Type**

**■ Dimensions**

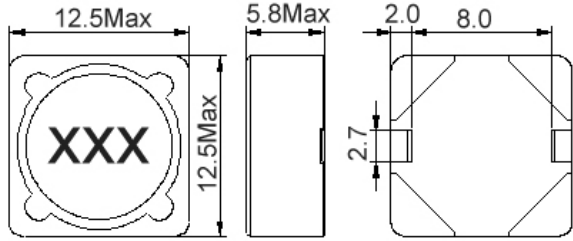

unit:mm

**■ Recommended Land Pattern**

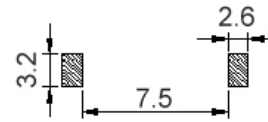

unit:mm

**■ Electrical Characteristics**

Part No.	Inductance (uH)	Test Freq.	SRF (MHz)Min	RDC (mΩ)Max.	Isat (A)	Irms (A)	Tolerance (±%)	Marking
SLFA1255T-6R0□-AU	6.0	1 kHz,1 V	26	19.7	3.6	4.9	30	6R0
SLFA1255T-100□-AU	10	1 kHz,1 V	17	25.8	3.4	4.3	20	100
SLFA1255T-150□-AU	15	1 kHz,1 V	15	31.0	2.8	3.9	20	150
SLFA1255T-220□-AU	22	1 kHz,1 V	11	40.6	2.3	3.4	20	220
SLFA1255T-330□-AU	33	1 kHz,1 V	10	49.8	1.9	3.1	20	330
SLFA1255T-470□-AU	47	1 kHz,1 V	8	74.2	1.6	2.5	20	470
SLFA1255T-680□-AU	68	1 kHz,1 V	7	99.8	1.3	2.2	20	680
SLFA1255T-101□-AU	100	1 kHz,1 V	5.5	140	1.1	1.8	20	101
SLFA1255T-151□-AU	150	1 kHz,1 V	4.5	228	0.88	1.4	20	151
SLFA1255T-221□-AU	220	1 kHz,1 V	3.0	324	0.72	1.2	20	221
SLFA1255T-331□-AU	330	1 kHz,1 V	3.0	492	0.59	1.0	20	331
SLFA1255T-471□-AU	470	1 kHz,1 V	2.5	624	0.49	0.88	20	471
SLFA1255T-681□-AU	680	1 kHz,1 V	2.0	912	0.43	0.73	20	681
SLFA1255T-102□-AU	1000	1 kHz,1 V	1.7	1344	0.34	0.60	20	102
SLFA1255T-152□-AU	1500	1 kHz,1 V	1.4	2076	0.29	0.48	20	152

**Note: When ordering, please specify tolerance code. Tolerance: M=±20% / T=±30%**

1. Operating temperature range - 40°C ~ 125°C(Including self - temperature rise)
2. Isat for Inductance drop 10% from its value without current.
3. Irms for a 30°C temperature rise from 25°C ambient.

4. Measure Equipment:

- L: WK6500B+WK6565
- RDC: Chroma 16502
- Isat: WK3260B+WK3265B

**Power Inductor SLFA Series**

**Automotive  
AEC-Q200**

**SLFA1255 - AU Type**

**Characteristics Graph**

**Inductance vs. Frequency Charateristics**

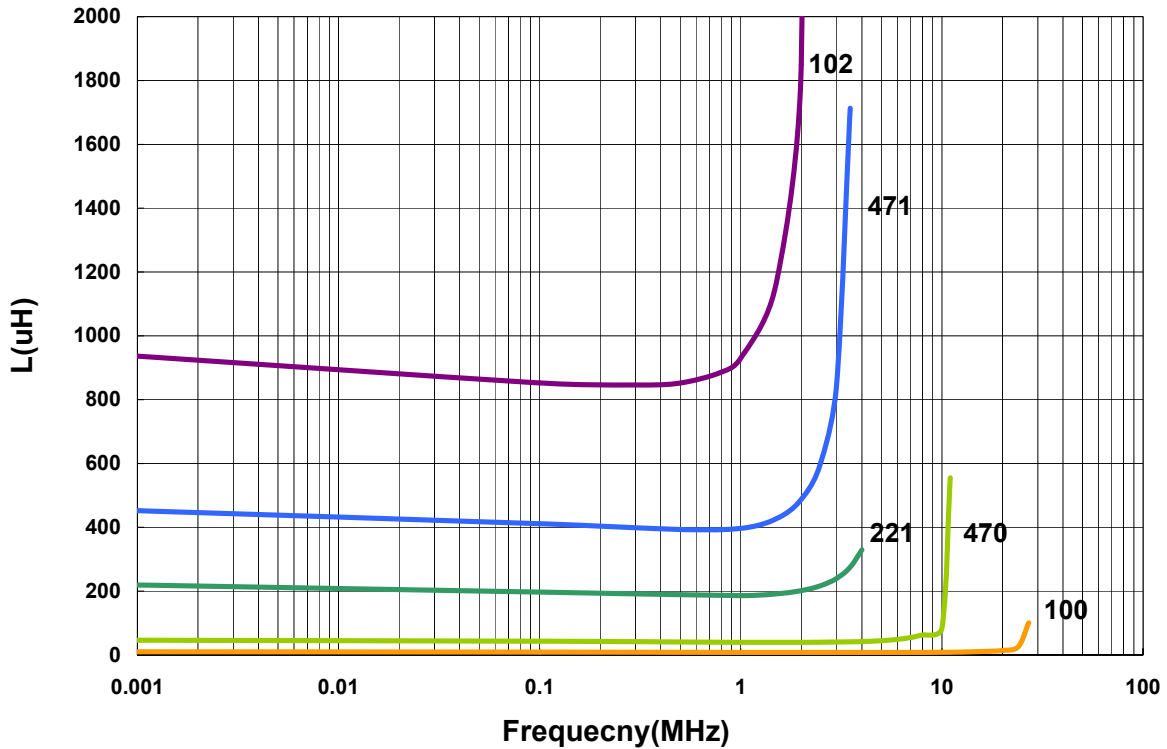

**Inductance vs. DC Current**

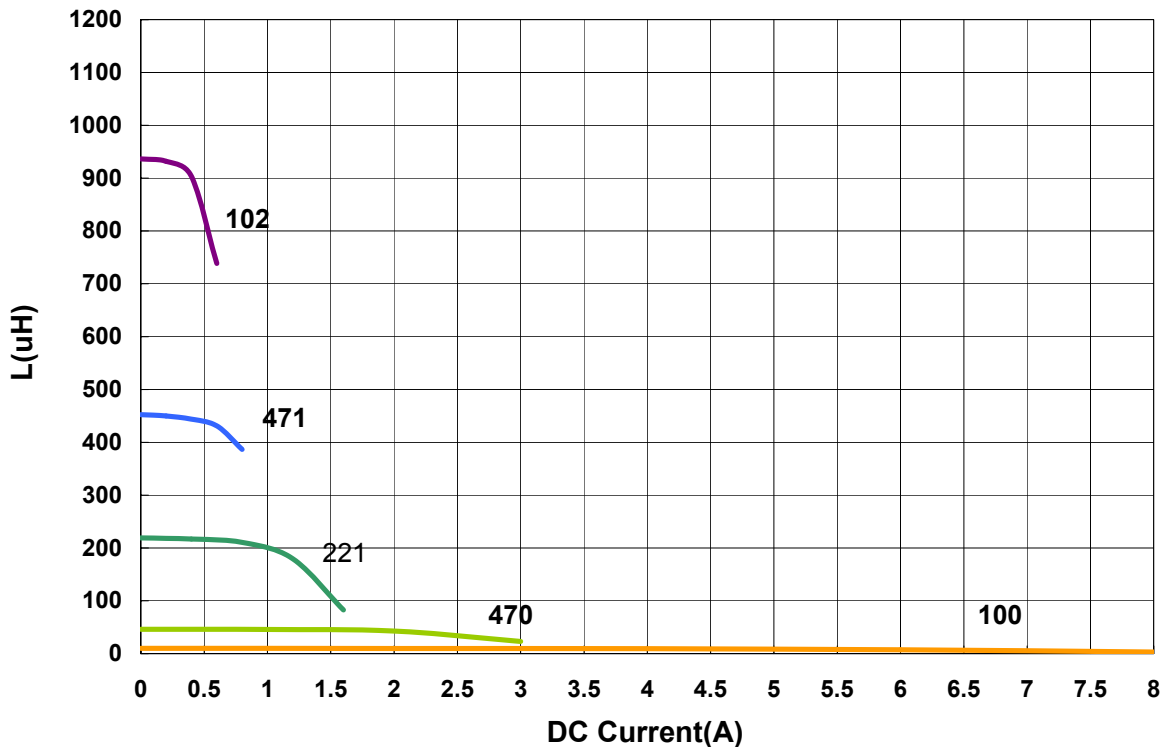

"Please be sure to request approval specifications that provide further details of the products. Kindly note that the content of these specifications are subject to change or may be discontinued without advance notice. Please contact our sales department before ordering."

**Power Inductor SLFA Series**

**Automotive  
AEC-Q200**

**SLFA5D28 - AU Type**

**■ Dimensions**

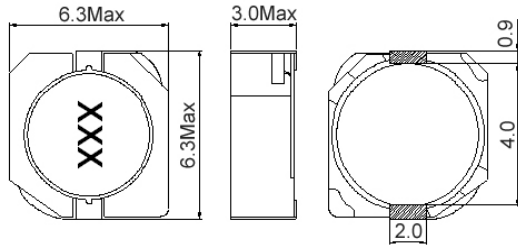

unit:mm

**■ Recommended Land Pattern**



unit:mm

**■ Electrical Characteristics**

Part No.	Inductance (uH)	Test Freq.	SRF (MHz)Min	RDC (mΩ)Max.	Isat (A)	Irms (A)	Tolerance (±%)	Marking
SLFA5D28T-6R8□-AU	6.8	100 kHz,1 V	35	42	1.50	2.20	20	6R8
SLFA5D28T-100□-AU	10	100 kHz,1 V	20	63.8	1.30	1.80	20	100
SLFA5D28T-150□-AU	15	100 kHz,1 V	15	89.4	1.00	1.40	20	150
SLFA5D28T-220□-AU	22	100 kHz,1 V	10	124	0.77	1.30	20	220
SLFA5D28T-330□-AU	33	100 kHz,1 V	7	177	0.69	1.10	20	330
SLFA5D28T-470□-AU	47	100 kHz,1 V	5	252	0.59	0.92	20	470
SLFA5D28T-680□-AU	68	100 kHz,1 V	4	348	0.50	0.78	20	680
SLFA5D28T-101□-AU	100	100 kHz,1 V	4	516	0.42	0.64	20	101
SLFA5D28T-151□-AU	150	100 kHz,1 V	4	780	0.34	0.50	20	151
SLFA5D28T-221□-AU	220	100 kHz,1 V	3.2	1170	0.26	0.38	20	221

**Note: When ordering, please specify tolerance code. Tolerance: M=±20% / T=±30%**

1. Operating temperature range - 40°C ~ 125°C(Including self - temperature rise)
2. Isat for Inductance drop 30% from its value without current.
3. Irms for a 25°C temperature rise from 25°C ambient.
4. Measure Equipment:  
 L: WK6500B+WK6565  
 RDC: Chroma 16502  
 Isat: WK3260B+WK3265B



SCDS5D28 - AU Type

■ Characteristics Graph

Inductance vs. Frequency Charateristics

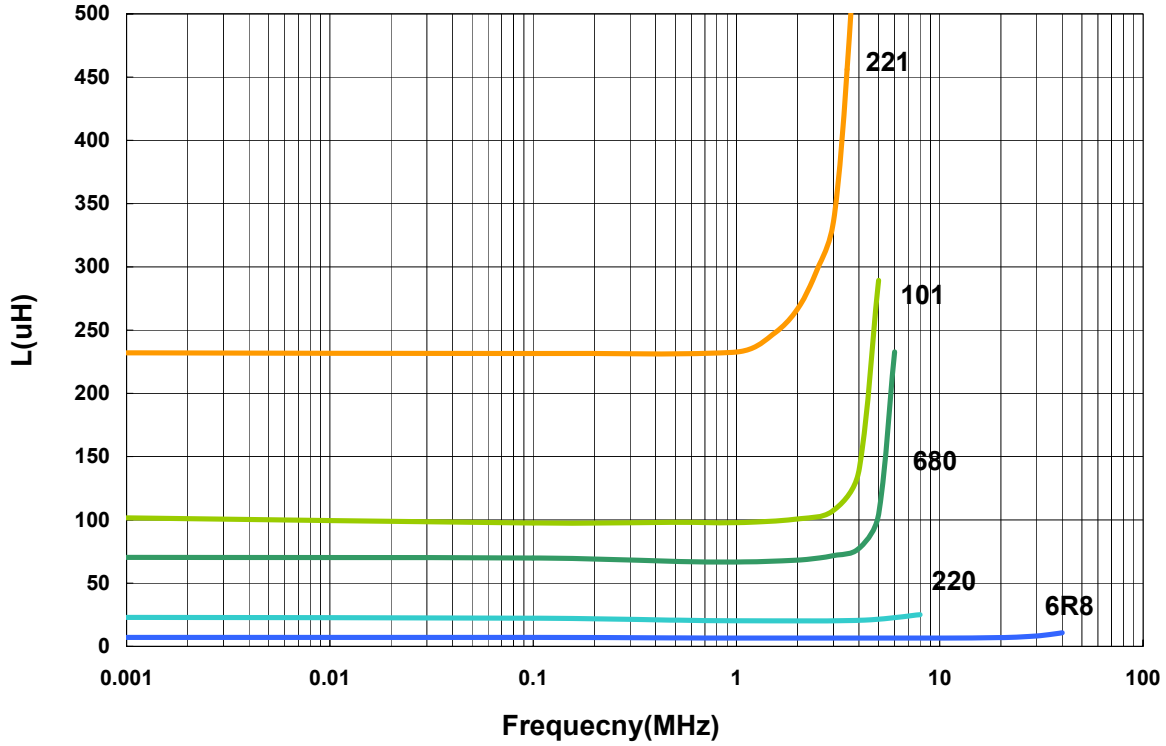

Inductance vs. DC Current

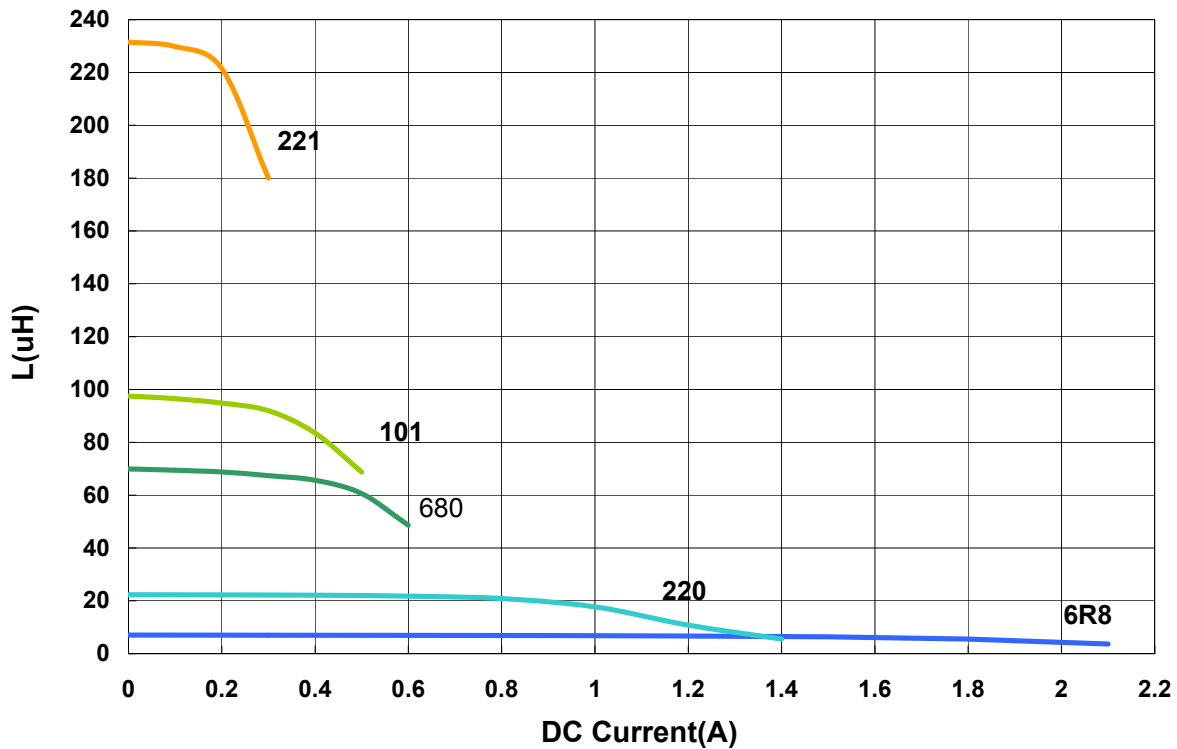

"Please be sure to request approval specifications that provide further details of the products. Kindly note that the content of these specifications are subject to change or may be discontinued without advance notice. Please contact our sales department before ordering."

**Power Inductor SLFA Series**

**Automotive  
AEC-Q200**

**■ Packaging**

Tape Dimensions

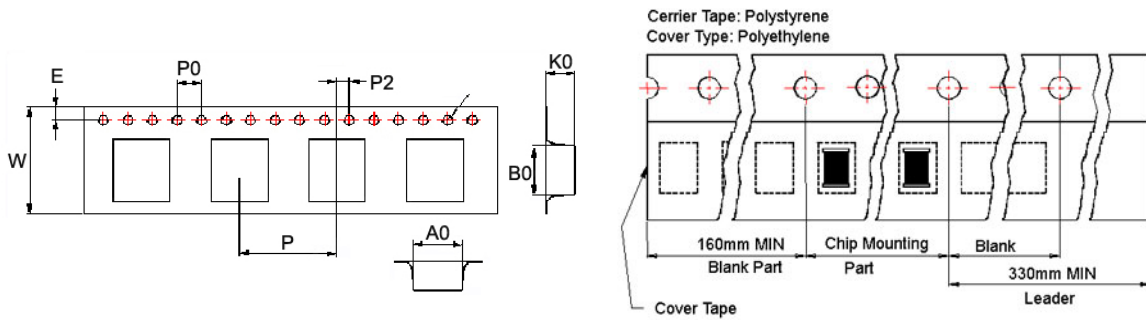

Reel Dimensions

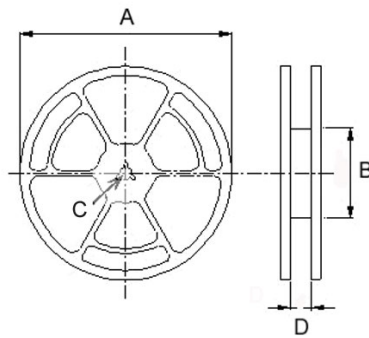

Dimensions in mm

TYPE	Tape Dimensions									Reel Dimensions				Quantity PCS / REEL
	A0	B0	K0	D	E	W	P	P0	P2	A	B	C	D	
SLFA 0745	7.6	7.6	5.2	1.55	1.75	16	12	4	2	330	100	13	16.0	1000
SLFA 0755	7.8	7.8	6.0	1.55	1.75	16	12	4	2	330	100	13	16.0	900
SLFA 1255	12.6	12.6	6.7	1.55	1.75	24	16	4	2	330	100	13	24.2	600
SLFA 5D28	6.3	6.55	3.3	1.55	1.75	16	12	4	2	330	100	13	16.0	1000